



## FFH Series Cartridge

### Introduction

The FFH Series is a replacement flat face cartridge coupler to suit the Faster FFI, FI '46 mm' & FFH, FH 48 mm housings. Designed for quick attachment change over for skid steer loaders, compact loaders, track loaders.

### Construction

- ◆ Carbon steel with trivalent plating
- ◆ Seals Nitril Buna-N
- ◆ Back up Teflon
- ◆ Internal Springs 302 Stainless Steel
- ◆ Series Interchange ISO 16028

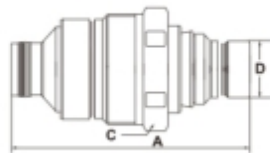
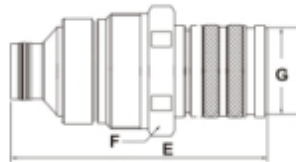

### Specification

- ◆ Operating temperature with standard NBR seals -20°C (-20°F) to 120°C (248°F)

Size	MWP PSI	Flow Rate	Force to Connect N
1/2	5000	110	213
3/4	5000	160	215

Part #	Size	Thread	E	F	G
FFHF-08M46	1/2	M46*1.5	102	42	38
FFHF-08M48	1/2	M48*1.5	103	50	38
FFHF-12M48	3/4	M48*1.5	110	50	48

Part #	Size	Thread	A	C	D
FFHM-08M46	1/2	M46*1.5	99	42	24.5
FFHM-08M48	1/2	M48*1.5	100	50	24.5
FFHM-12M48	3/4	M48*1.5	115	50	30

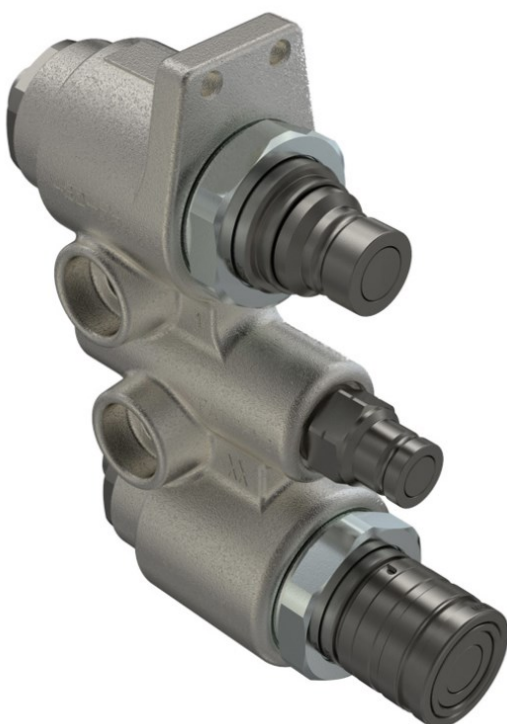

**4BD4FH Replacement Block**